

SOUTHWEST GAS CORPORATION  
 P.O. Box 98510  
 Las Vegas, Nevada 89193-8510  
 Nevada Gas Tariff No. 7

Canceling \_\_\_\_\_ Original \_\_\_\_\_ P.U.C.N. Sheet No. 98  
 P.U.C.N. Sheet No. \_\_\_\_\_

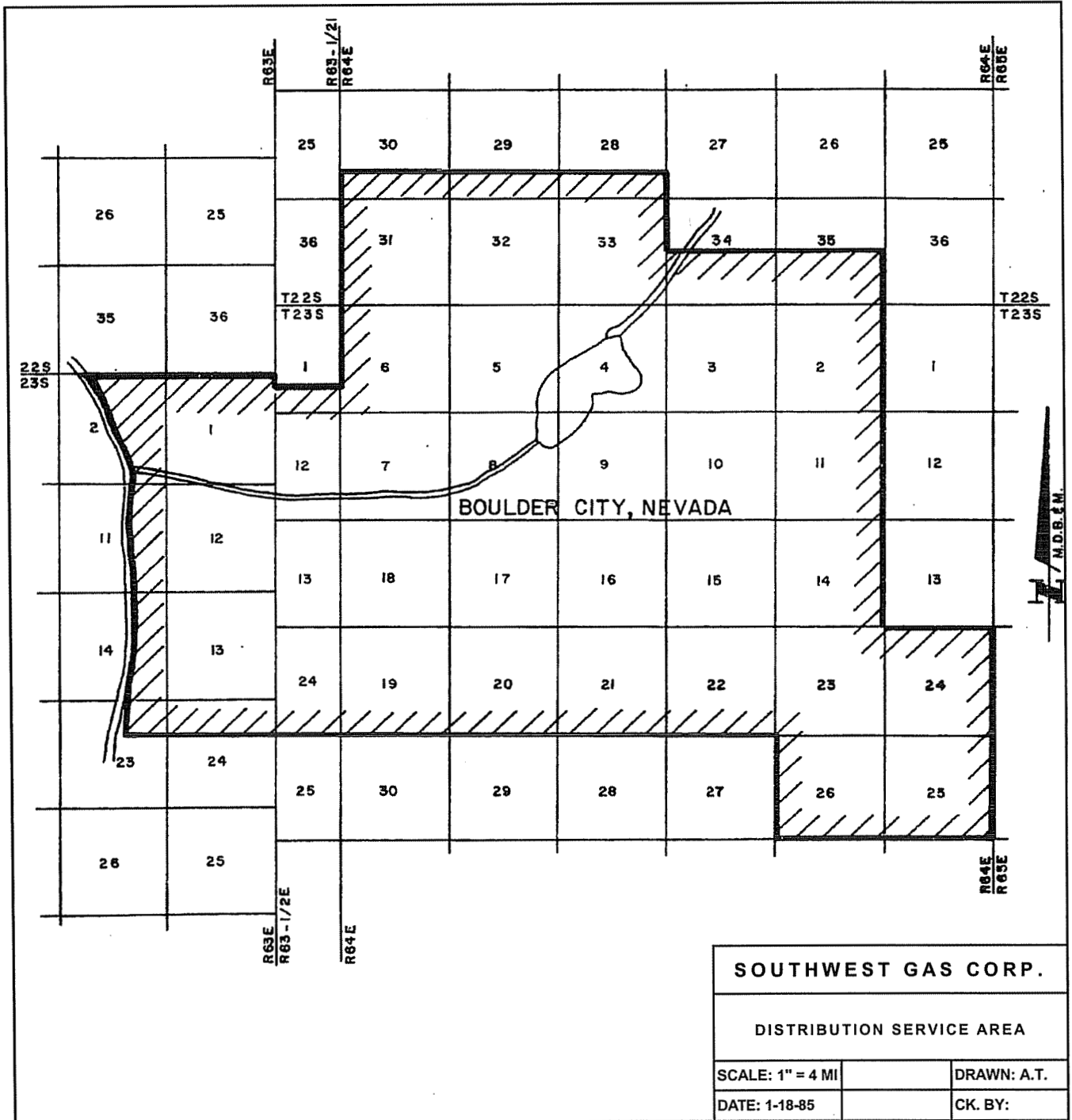

<b>SOUTHWEST GAS CORP.</b>		
DISTRIBUTION SERVICE AREA		
SCALE: 1" = 4 MI		DRAWN: A.T.
DATE: 1-18-85		CK. BY:

Issued:  
 November 10, 2009

Effective:  
 November 1, 2009

Advice Letter No.:

Issued by  
 John P. Hester  
 Senior Vice President

DESCRIPTION OF SERVICE AREA

The service area of Southwest Gas Corporation in or near Boulder City, County of Clark, State of Nevada, includes the following described area:

1. Township 23 South, Range 63 East, M.D.B.& M. All of Section 1; that portion of Section 2 lying easterly of the right-of-way of United States Highway 95; that portion of Section 11 lying easterly of the right-of-way of Highway 95 (now abandoned); all of Section 12; all of Section 13; that portion of Section 14 lying easterly of said right-of-way of Highway 95 (now abandoned) to a point being near the south boundary of said Section 14, said point being on the west line of Lot 8 and the easterly right-of-way line of said Highway; thence south along the west boundary of said Lot 8 to a point on the south boundary of said Section 14; the northeast quarter (NE 1/4) of the northeast quarter (NE 1/4) and Lots 1, 4 and 5 of Section 23; the north half (N 1/2) of the north half (N 1/2) and Lots 1, 2, 3 and 4 of Section 24.
2. Township 23 South, Range 63 1/2 East, M.D.B.& M. All of Lots 8, 9 and 10 of Section 1; all of fractional Sections 12, 13 and 24.
3. Township 22 South, Range 64 East, M.D.B.& M. The south half (S 1/2) of the south half (S 1/2) of Section 28; the south half (S 1/2) of the south half (S 1/2) of Section 29; the south half (S 1/2) of the southeast quarter (SE 1/4), the southeast quarter (SE 1/4) of the southwest quarter (SW 1/4) and Lot 12 of Section 30; all of Section 31; all of Section 32; all of Section 33; the south half (S 1/2) of Section 34; and the south half (S 1/2) of Section 35.
4. Township 23 South, Range 64 East, M.D.B.& M. All of Sections 2, 3, 4, 5, 6, 7, 8, 9, 10, 11, 14, 15, 16, 17, 18, 19, 20, 21, 22, 23, 24, 25 and 26.

Issued:  
November 10, 2009

Effective:  
November 1, 2009

Advice Letter No.:

Issued by  
John P. Hester  
Senior Vice President